

Bosch gen 2 lockring tool



1726.BL2

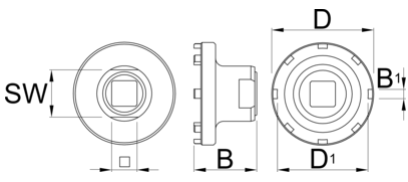

Product features

- Designed for the installation and removal of chainring lockrings on Bosch[®] Gen 2 e-bike motors.
- Precision-engineered with CNC machined premium flex plus carbon steel for superior durability and performance.
- Integrated 1/2" drive fitting ensures compatibility with our ratchet, fixed handle, and torque wrenches for convenient use.
- Compatible with Bosch Active Line, Performance Line, and Performance Line CX from model year 2014 onwards, with a 50 mm lockring outer diameter.
- This tool serves as a reliable replacement for the Bosch[®] 0275009003 tool.



|  | SW |  | D | D1 | B | B1 |  |
|--|----|---|------|------|----|-----|---|
| 629466 | 24 | 1/2" | 50.8 | 46.4 | 32 | 4.7 | 151 |

* Ürünlerin resimleri semboliktir. Bütün boyutlar mm ve ağırlık gram cinsindedir.

Usage (pictures)

