

手□□□机套装

1301/6



配置文件



□□□□

- □□□□□□
- 安装□□用4个□咀□件, 3.2 mm - 6.4 mm (1/8" - 1/4")
- 安装盲孔□□螺母的5个□咀□件, 从M4至M10 (R5/32" - R3/8")
- 工具配有SOS工具□, 可配合Unior工具□使用
- 上漆的重型把手



619880



495



2200

* Images of products are symbolic. All dimensions are in mm, and weight in grams. All listed dimensions may vary in tolerance.

用途 (pictures)

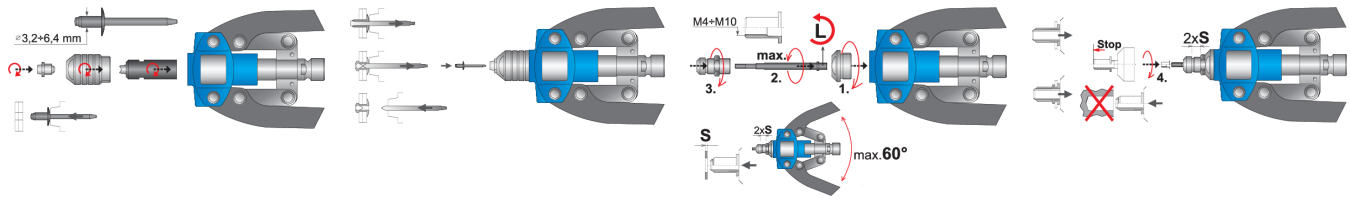

配件

 1301/6的盲孔 螺母 咀 件

Related products

 手 机