

双高□套筒扳手

177



配置文件



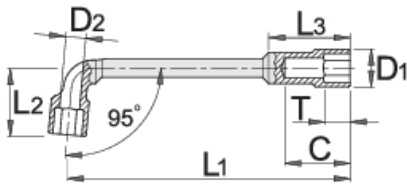

□□□□

- 材料：□□□
- 落□，完全淬火与回火
- 表面□理：根据ISO 1456:2009□□□□



□□□□	mm	L1	L2	C	D1	T	L3	D2	□
609083	8	113	26	27	13	10	30	6,5	76
609084	9	118	27	29	14,5	10	33	7	78
609085	10	123	31	32	16	11	35	7,5	123
609086	11	128,5	32	31	17	12	37	7,5	125
609087	12	135	33	34	18	12	40	8,5	161

		L1	L2	C	D1	T	L3	D2	
609088	13	143	36,5	40	19	11	47	9	186
609089	14	149,5	40	41	21	14	48	10,5	226
609090	15	163	41,5	43	22,5	15	50	11	236
609091	16	173	46,5	47	24	17	54	13	340
609092	17	184,5	46,5	49	25	18	56	13	360
609093	18	198	49	51,5	26,5	19,5	58	13	411
609094	19	204	52	52,5	28	20,5	62	14	445
609095	20	207	53,5	54,5	30	21,5	63	14	495
609096	21	216	57	57,7	30,5	23,5	65	15	487
609097	22	231	57	58	32	23,5	67	16	590
609098	23	238	62	64,5	33,5	24,5	74	18	640
609099	24	249	64,5	68,5	34,5	25,5	77	18	713

* Images of products are symbolic. All dimensions are in mm, and weight in grams. All listed dimensions may vary in tolerance.

用途 (pictures)

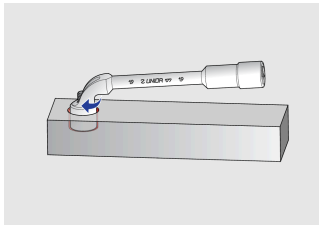

扳手的形状和开口使其可以在螺栓上拧紧螺母

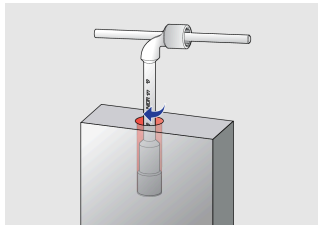

通过其深的剖面，此扳手也可通过螺母和螺栓，作套筒扳手使用。

