

Zündkerzen Rohrsteckschlüssel, sechskant

185/2







Profile

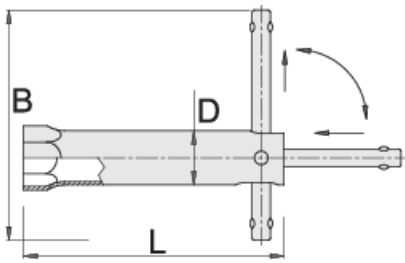

Produkteigenschaften

- Material: Premium Chrom-Vanadium-Stahl
- verchromt gemäß Industriestandard ISO 1456:2009



		D	L	B	
600771	16	19	145	120	182
607956	19	22	115	120	199
600772	21	24	115	120	177
600773	21	24	180	120	248

* Bilder von Produkten sind Symbolfotos. Abmessungen sind in mm, Gewichte in Gramm.