

Dopsleutel-schroevendraaier 3/8" ZX

236/2ZX

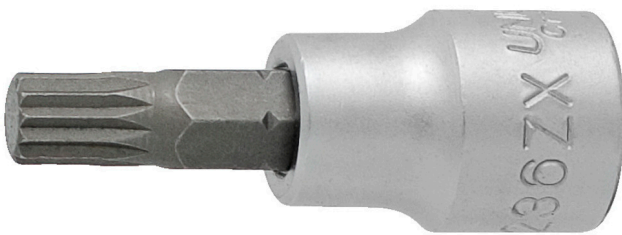





Profielen

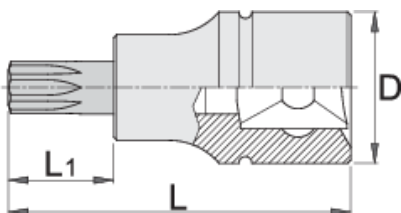

Product attributen

- materiaal: dop: chroom vanadium, verchroomd
- material: bit from premium plus carbon steel
- entirely hardened and tempered
- made according to standard DIN 2324



		L	L1	D	
612113	M5	48	22	18	37
612114	M6	48	22	18	39



L

L1

D



612115

M8

48

22

18

46

* Afbeeldingen van producten zijn symbolisch. Alle afmetingen zijn in mm, en het gewicht in grammen. Alle vermelde afmetingen kunnen variëren in tolerantie.