

# 批口接

188.9



## 配置文件



□□□□

- 材料：特种工具□
- 落□，完全淬火与回火
- 表面□理：根据ISO 1456:2009□□□□

## 用途：

- 适用于刀□E6,3, C6,3

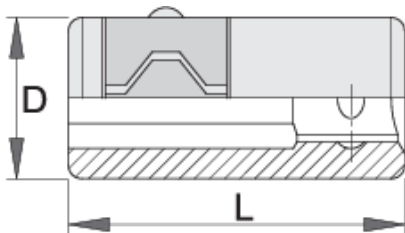

612867



1/4" - 1/4"

L

25

D

12



18

\* Images of products are symbolic. All dimensions are in mm, and weight in grams. All listed dimensions may vary in tolerance.