

# Kurbağacık

250/1



## Profiles



## Standards

ISO 6787

## Product features

- malzeme: krom vanadyum
- sıcak dövme, tamamen sertleştirilmiş ve temperlenmiş
- yüzey bitirme: ISO 1456:2009 standardına göre krom kaplamalı
- cilalı başlık
- ölçekli
- DIN 6787 standardına göre yapılmıştır

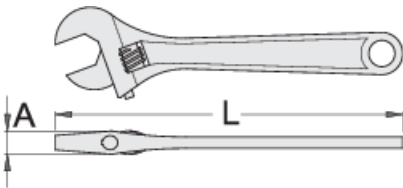

611917



100



4"

L

108.4

A



10.5



13



61

			L	A		
611918	150	6"	157.4	13	19	133
601016	200	8"	205.9	15	24	243
601017	250	10"	255.5	17	27	439
601018	300	12"	306.1	20	34	702
601019	380	16"	383	26	41	1315
605113	450	18"	460.5	32	48	1730
615148	600	24"	612.3	36	57	3240

\* Ürünlerin resimleri semboliktir. Bütün boyutlar mm ve ağırlık gram cinsindedir.

## Usage (pictures)

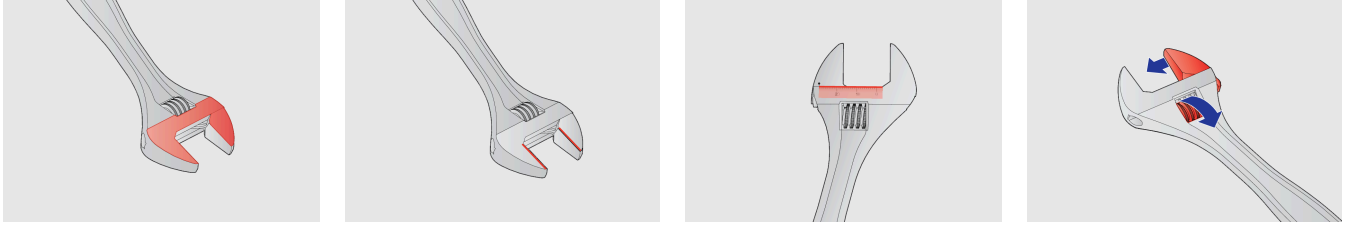

## Spare parts



250/1, 250/1A kurbağacık için yedek parçalar

## Safety tips



- Discard any wrench with a spread or damaged fixed jaw or a bent handle

# Safety (pictures)

