

# Ključ podešavajući

250/1



## Profili



## Zatvori pretraživanje

ISO 6787

## Atributi proizvoda

- Materijal: Premium krom-vanadij
- Kovan, u cijelosti ojačan i zakaljen
- kromirani (ISO 1456:2009)
- Polirane glave
- Sa mjernom skalom
- Izrađen prema standardu ISO 6787

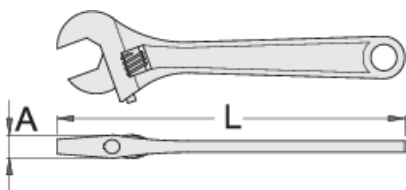

611917



100



4"

L

108.4

A





10.5



13



61

			L	A		
611918	150	6"	157.4	13	19	133
601016	200	8"	205.9	15	24	243
601017	250	10"	255.5	17	27	439
601018	300	12"	306.1	20	34	702
601019	380	16"	383	26	41	1315
605113	450	18"	460.5	32	48	1730
615148	600	24"	612.3	36	57	3240

\* Slike proizvoda su simbolične. Sve dimenzije su u mm, masa je u g.

## upotreba (pictures)

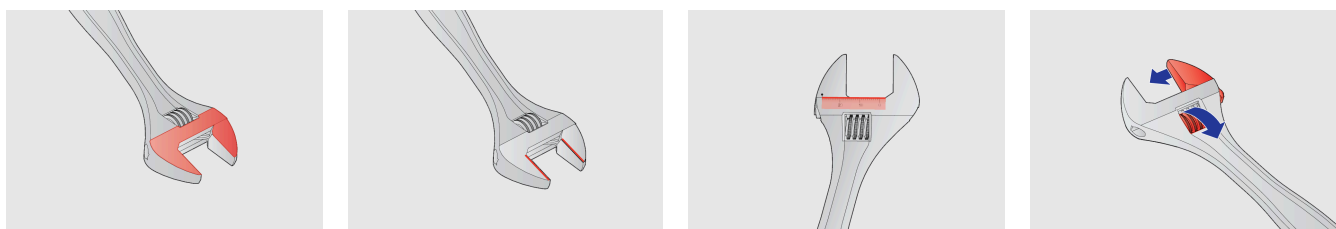

## Rezervni dijelovi



Rezervni dijelovi za art. 250 i 250 A

## Safety tips



- Discard any wrench with a spread or damaged fixed jaw or a bent handle

# Safety (pictures)

