

Izvlakač dvokraki klizni

683/2



Profili



Atributi proizvoda

- materijal: Premium Flex Plus alatni čelik
- kovana, potpuno poboljšana i ojačana
- završna obrada: kromiranje prema standardu ISO 1456:2009, vijak bruniran
- krakove dobro pričvrstiti pod dio koji se izvlači

Prednosti:

- okretanjem krakova, izvlakač postaje unutrašnji ili vanjski

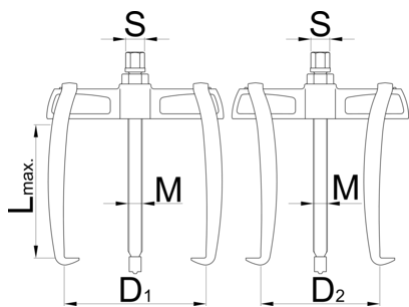

| | N ^o | L [↑] | D1 | D2 | F_{max} → | t_{max} → | M | S | |
|--------|----------------|----------------|-----|-----------|-------------|-------------|----------|----|------|
| 615076 | 60 | 90 | 65 | 50 - 90 | 25 | 2.5 | M 10x1 | 13 | 325 |
| 615077 | 90 | 90 | 90 | 50 - 110 | 25 | 2.5 | M 10x1 | 13 | 395 |
| 615078 | 130 | 140 | 130 | 80 - 140 | 50 | 5 | M 14x1,5 | 17 | 1125 |
| 615079 | 180 | 140 | 180 | 80 - 180 | 50 | 5 | M 14x1,5 | 17 | 1225 |
| 615080 | 250 | 195 | 250 | 130 - 250 | 75 | 7.5 | M 22x2 | 24 | 4025 |
| 615081 | 350 | 195 | 350 | 130 - 350 | 75 | 7.5 | M 22x2 | 24 | 4525 |

* Slike proizvoda su simbolične. Sve dimenzije su u mm, masa je u g.

upotreba (pictures)



Rezervni djelovi

Krak

Related products



Izvlakač dvokraki



Izvlakač dvokraki klizni



Izvlakač trokraki

Safety (pictures)

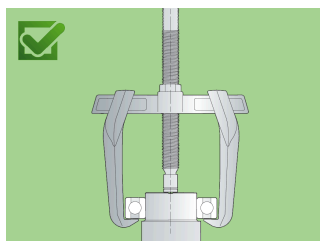
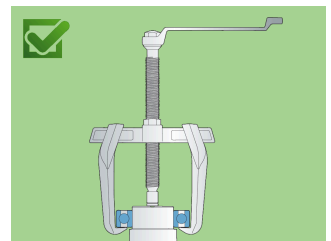
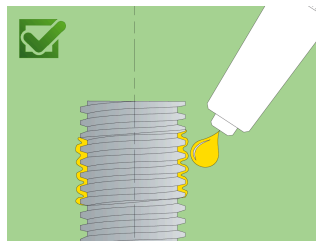
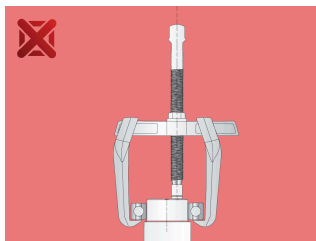
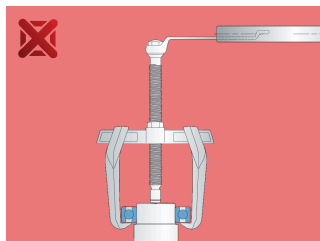
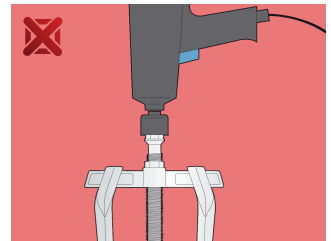
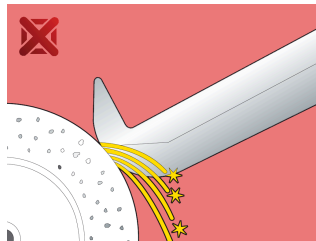
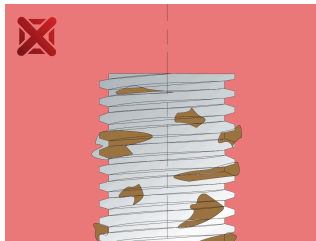

Frequently asked questions

Can we achieve greater pulling force using a three-arm puller compared to a two-arm puller?

It depends on the dimensions. In principle, yes, because the force is distributed over several arms.

One arm broke. Do I have to replace all the arms or just the broken one?

It is necessary to change all the arms.