

Izvlakač dvokraki klizni

683/2



Profili



Atributi proizvoda

- materijal: poseban alatni čelik
- kovana, potpuno poboljšana i ojačana
- završna obrada: kromiranje prema standardu ISO 1456:2009, vijak bruniran
- krakove dobro pričvrstiti pod doji koji se izvlači

Prednosti:

- okretanjem krakova, izvlakač postaje unutrašnji ili vanjski

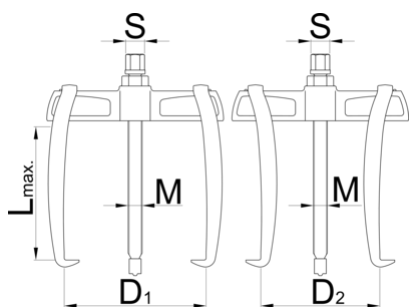

	No	L↑	D1	D2	F_{max} →	t_{max} →	M	S	
615076	60	90	65	50 - 90	25	2.5	M 10x1	13	325
615077	90	90	90	50 - 110	25	2.5	M 10x1	13	395
615078	130	140	130	80 - 140	50	5	M 14x1,5	17	1125
615079	180	140	180	80 - 180	50	5	M 14x1,5	17	1225
615080	250	195	250	130 - 250	75	7.5	M 22x2	24	4025
615081	350	195	350	130 - 350	75	7.5	M 22x2	24	4525

* Slike proizvoda su simbolične. Sve dimenzije su u mm, masa je u g.

Upotreba (pictures)



Rezervni dijelovi

 Krak

Related products



Izvlakač dvokraki



Izvlakač dvokraki klizni



Izvlakač trokraki

Safety (pictures)

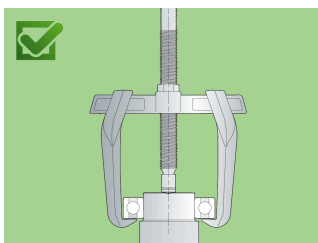
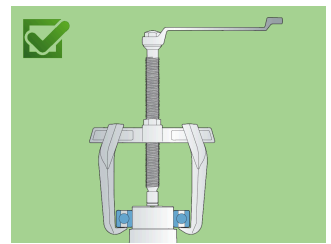
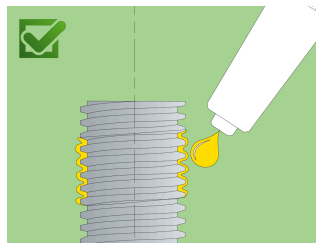
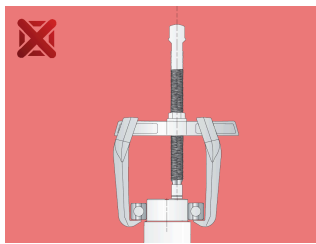
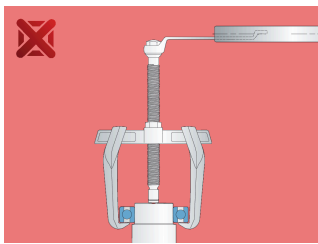
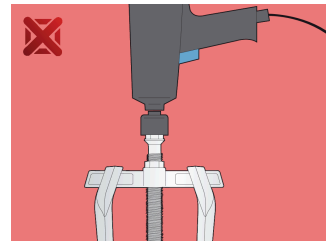
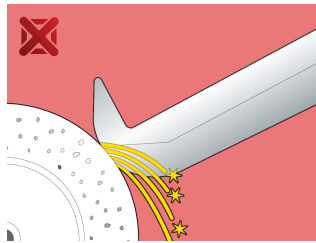
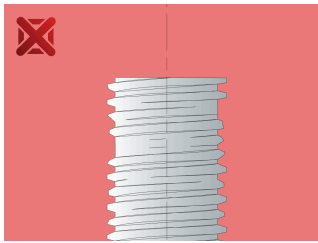

Frequently asked questions

Can we achieve greater pulling force using a three-arm puller compared to a two-arm puller?

It depends on the dimensions. In principle, yes, because the force is distributed over several arms.

One arm broke. Do I have to replace all the arms or just the broken one?

It is necessary to change all the arms.