

Abzieher mit zwei Gleit- Umkehrarmen

683/2



Profile



Produkteigenschaften

- Material: Körper aus Premium Flex Plus Kohlenstoffstahl, Arm aus Premium Chrom-Vanadium-Stahl
- geschmiedet, gehärtet und vergütet
- Oberfläche verchromt nach Standard ISO 1456:2009, Schraube brüniert
- Selbstspannend

Vorteile:

- innen und außen verwendbar

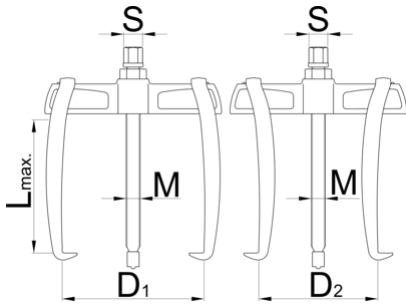

	Nº	L↑	D1	D2	I_{Fmax} →	I_{tmax} →	M	S	
615076	60	90	65	50 - 90	25	2.5	M 10x1	13	325
615077	90	90	90	50 - 110	25	2.5	M 10x1	13	395
615078	130	140	130	80 - 140	50	5	M 14x1,5	17	1125
615079	180	140	180	80 - 180	50	5	M 14x1,5	17	1225
615080	250	195	250	130 - 250	75	7.5	M 22x2	24	4025
615081	350	195	350	130 - 350	75	7.5	M 22x2	24	4525

* Bilder von Produkten sind Symbolfotos. Abmessungen sind in mm, Gewichte in Gramm.

Verwendung (Bilder)



Ersatzteile



Arm

— Spindel

Verwandte Produkte



Abzieher mit zwei Armen



Abzieher mit zwei Gleit-Umkehrarmen



Abzieher mit drei Armen

Sicherheit (Bilder)

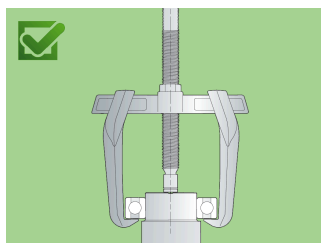
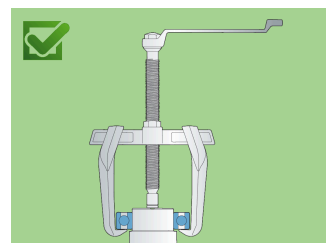
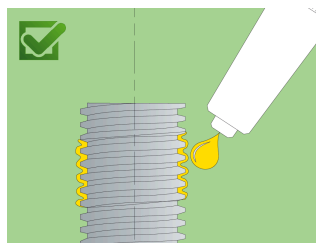
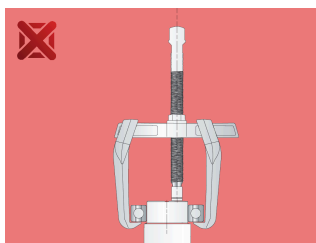
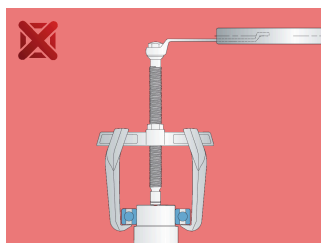
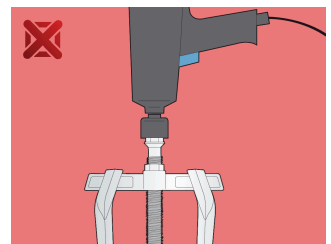
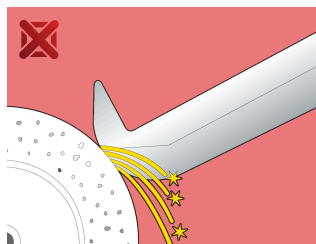
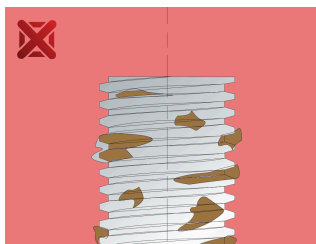
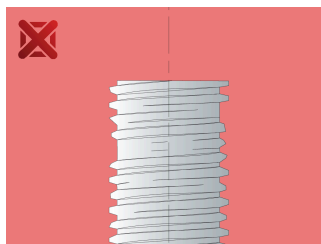

Häufig gestellte Fragen

Can we achieve greater pulling force using a three-arm puller compared to a two-arm puller?

It depends on the dimensions. In principle, yes, because the force is distributed over several arms.

One arm broke. Do I have to replace all the arms or just the broken one?

It is necessary to change all the arms.