

Radapciger me dy krahë rrëshqitës

683/2



Profiles



Product features

- Materiali: çeliku të veçantë mjet
- rënie të falsifikuara, ngurtësuar tërësisht dhe nevrík
- përfundojë sipërfaqe: krom kromuar sipas ISO 1456:2009, vidhos nxirë
- kthetrat veprim levë përshtaten ngushtë me pjesën që të hiqet

Avantazhet:

- duke përmbytur krahët, voztar mund të përdoret si voztar brendshme apo të jashtme

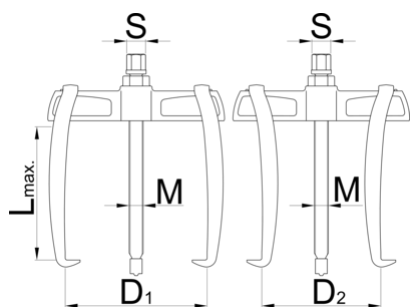

	N ^o	L [↑]	D1	D2			M	S	
615076	60	90	65	50 - 90	25	2.5	M 10x1	13	325
615077	90	90	90	50 - 110	25	2.5	M 10x1	13	395
615078	130	140	130	80 - 140	50	5	M 14x1,5	17	1125
615079	180	140	180	80 - 180	50	5	M 14x1,5	17	1225
615080	250	195	250	130 - 250	75	7.5	M 22x2	24	4025
615081	350	195	350	130 - 350	75	7.5	M 22x2	24	4525

* Imazhet e produkteve janë simbolike. Të gjitha dimensionet janë në mm, pesha në gram. Të gjitha dimensionet e listuara mund të ndryshojnë në tolerancë.

Usage (pictures)



Spare parts



Krah

Related products



Radapciger me 2 krahë



Radapciger me dy krahë rrëshqitës



Radapciger me tre krahë

Safety (pictures)

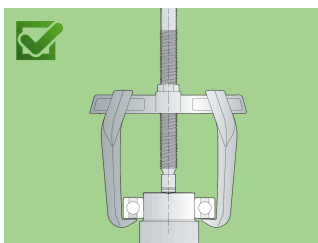
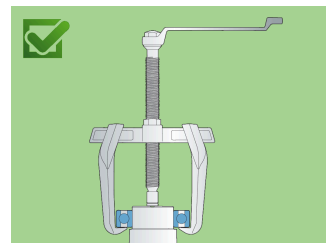
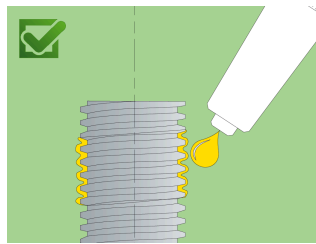
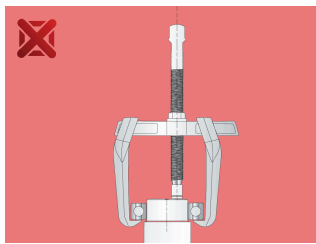
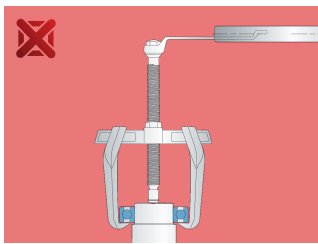
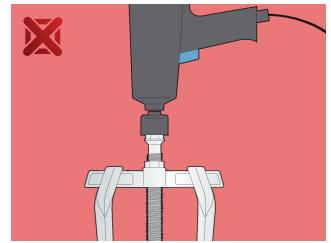
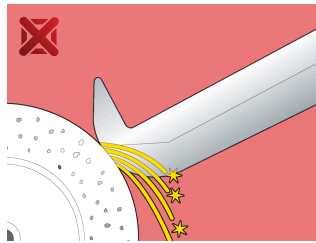
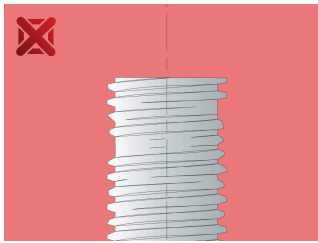

Frequently asked questions

Can we achieve greater pulling force using a three-arm puller compared to a two-arm puller?

It depends on the dimensions. In principle, yes, because the force is distributed over several arms.

One arm broke. Do I have to replace all the arms or just the broken one?

It is necessary to change all the arms.