

# Puller with two sliding arms

681/2



## Profiles



## Product features

- material: body from premium flex plus carbon steel, arm from premium chrome vanadium steel
- drop forged, entirely hardened and tempered
- surface finish: chrome plated according to ISO 1456:2009, screw blackened

## Advantages:

- by reversing the arms, the puller can be used as internal or external puller
- sturdy design for very heavy duty work

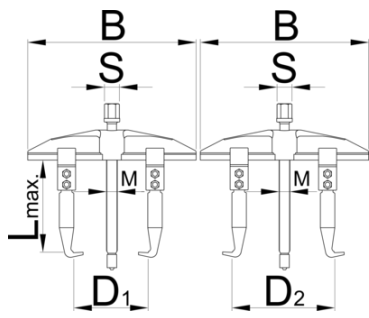

	Nº	B	D1	D2	L↑			M	S	
601765	300	280	70 - 220	110 - 260	150	65	6.5	M 20 x 2	22	3355
601766	400	450	110 - 360	190 - 450	200	110	11	M 22 x 2	32	8725

\* Images of products are symbolic. All dimensions are in mm, and weight in grams. All listed dimensions may vary in tolerance.

## Usage (pictures)

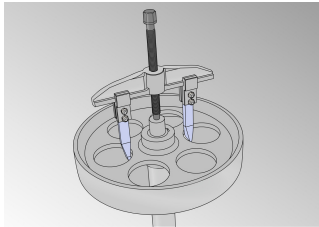

## Spare parts

Arm

Spindle

## Related products



Puller with two adjustable arms



Puller with two sliding arms



Puller with three adjustable arms

## Safety (pictures)

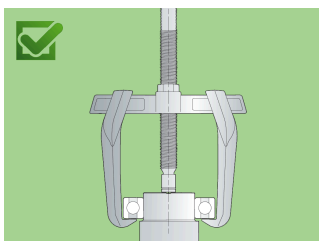
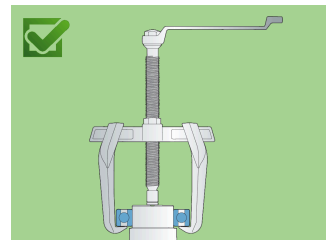
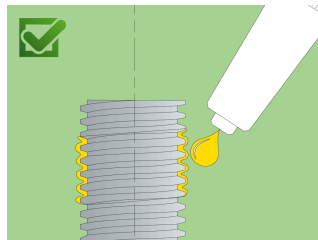
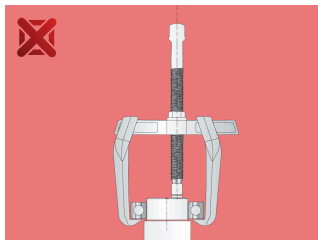
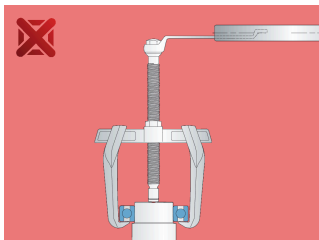
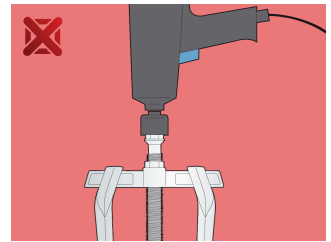
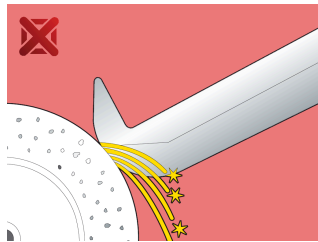
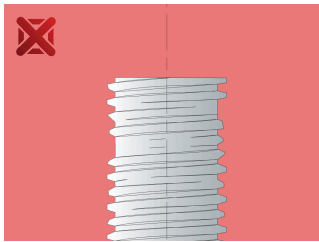

## Frequently asked questions

**One arm broke. Do I have to replace all the arms or just the broken one?**

It is necessary to change all the arms.