

Separator puller

2026/2



Profiles



Product features

- material: body from premium flex plus carbon steel, arm from premium chrome vanadium steel
- Surface finish of screws: burnished, other parts are chrome-plated

- The separator puller is a tool designed to efficiently dismount various machine parts attached to shafts.
- It is indispensable for tasks requiring the safe and deformation-free dismounting of firmly fixed machine parts.
- Our product range includes three sizes of pullers used for taking off objects from shafts. They range from Ø5mm to Ø115mm.

Advantages:

- The separator puller consists of a yoke, a spindle, two arms and a gripper assembly, which together allow uniform dismounting.
- The separator puller is designed to allow easy and safe operation

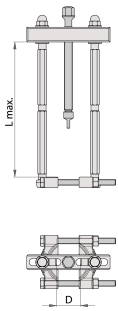

Barcode	D	L ↑	F _{max} →	t _{max} →	Icon
619273	5 - 60	229	20	2	2160
619274	12 - 75	234	35	3.5	2930
619275	22 - 115	325	50	5	7180

* Images of products are symbolic. All dimensions are in mm, and weight in grams. All listed dimensions may vary in tolerance.

Usage (pictures)

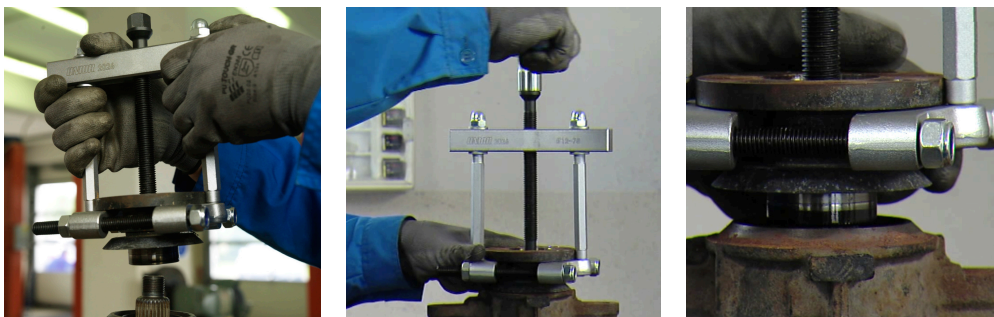

Spare parts

— Spindle for 2026/2

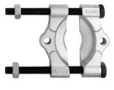

Pulling cup for 2026/2

Related products



Puller with two adjustable arms



Puller with three adjustable arms

Safety (pictures)

