

Kliješta, univerzalna

447/1VDEBI



Profili



Standardi

DIN EN IEC 60900 (VDE 0682-201):2019-04; EN IEC 60900:2018

Atributi proizvoda

- materijal: krom-vanadij
- kovana, potpuno poboljšana i ojačana
- prihvatne površine induktivno zakaljene
- završna obrada: kromiranje po standardu ISO 1456:2009
- robusne ručke izolirane dvokomponentnim navlakama
- izrada prema standardu ISO8976 i EN IEC 60900

Prednosti:

- podešavanje otvora čeljusti u 7 položaja
- Posebna izbočina sprječava uklještenje prstiju između drški kliješta

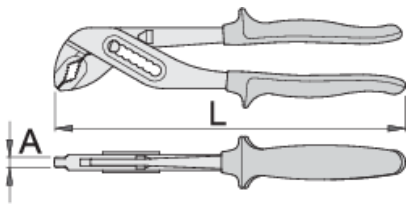

L

A

Omax



611993

240

6.5

35

367

* Slike proizvoda su simbolične. Sve dimenzije su u mm, masa je u g.

Upotreba (pictures)

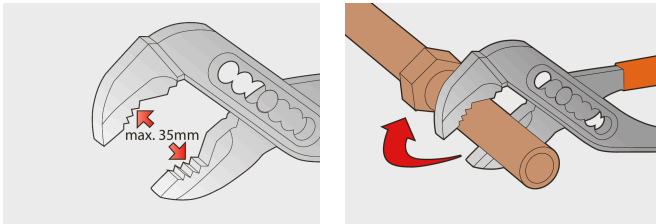

Frequently asked questions

Are certified insulated tools made through a different procedure than non-certified insulated tools?

The tools are made according to the same procedure.

Are insulated (VDE) tools considered as personal protective equipment (PPE)?

According to EU regulations, VDE tools are not considered as PPE.

Is it possible to work with insulated pliers under electrical voltage?

Yes, but only by professionals who follow safety requirements and use additional personal protective equipment.

Are the VDE tools only being sampled in series production?

The high voltage test (at 10kV) is performed fully on each tool. Other tests are performed in accordance with the EN60900 standard.