

Gereedschapswagen Europlus

940PLUS3

NIEUW



Product attributen

- material: premium PLUS sheet metal
- central locking system with a lock and folding key
- slot met sleutel, ook schuimrubberen sleutelhanger meegeleverd
- oil and acid resistant casters of a diameter of 125mm, one with brake, which blocks spinning and swiveling of the caster
- corners protected with anti-shock rubber
- 7 drawers (5x L 563 x W 365 x H 70mm, 2x L 563 x W 365 x H 150mm)
- basic dimensions with handle and casters L 801 x W 524 x H 931mm
- static load capacity of carriages without casters: 2000 kg
- dynamic load capacity of carriages: 500 kg
- maximum capacity of each drawer: 45kg

- coated with eco colour of Qualicoat quality standard
- total volume of drawers: 137 litres
- laden compatibel met SOS-gereedschapsmousse 1/3, 2/3, 3/3
- wide range of accessories

Voordelen:

- full extension drawers with soft closing mechanism
- ergonomic handle for easy opening of drawer
- drawer fronts can be customized with graphic design as separate order
- improved colour durability

Why Choose Unior:

- Unior is a renowned name in the tool industry, synonymous with quality and reliability. With century of experience, Unior products are trusted by professionals worldwide for their superior performance and innovative design.

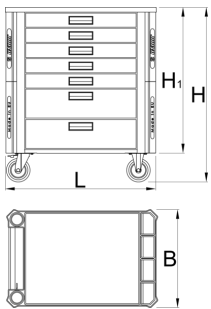

Barcode	L	B	H	H1	Weight
629590	801	524	931	778	61600

* Afbeeldingen van producten zijn symbolisch. Alle afmetingen zijn in mm, en het gewicht in grammen. Alle vermelde afmetingen kunnen variëren in tolerantie.

Gebruik (Afbeeldingen)





Accessoires



Houder voor AKU schroevendraaier



Houder voor hamers



Houder met pin



Houder voor tangen



Houder voor schroevendraaiers

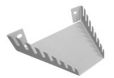

Houder voor sleutels



Bottle holder 940ECO



Set van kunststof boxen met bodemplaat



Base pade for plastic boxes



Hakenset, 10 stuks



Dubbele hakenset, 10 stuks

Onderdelen



Lock with keys



Set of casters

Gerelateerde producten



Gereedschapswagen Euromotion



Gereedschapswagen Hercules