

Measuring - convert tables

C 6.3	s1↑	s1↓	d3	e1↑	e1↓	L1	L3	r↓	inch
	6,350	6,292	6,7	7,18	7,11	11,0	8,2	0,3	1/4"

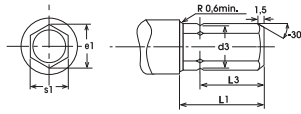

C 8	s1↑	s1↓	d3	e1↑	e1↓	L1	L3	r↓	inch
	7,930	7,872	8,2	8,96	8,90	13,5	10,2	0,3	5/16"

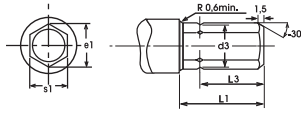

E6.3	s1↑	s1↓	d3	e1↑	e1↓	L1	L3	L7	r↓	inch
	6,350	6,292	4,7	7,18	7,11	25,0	9,5	1,0	2,4	1/4"

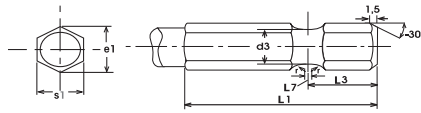

		PHILLIPS & POZIDRIV/SUPRADRIV SCREWS									
		Metric screws			Screw			Wood screws			
		Flat head	Oval head	Pan head	Pan head	Flat head	Oval head	Pan head	Round head	Oval head	
		+	+	+	+	+	+	+	+	+	
		+	+	+	+	+	+	+	+	+	
		PHILLIPS	POZIDRIV								
		Min. Torque									
		DIN	DIN	DIN	DIN	DIN	DIN	DIN	DIN	DIN	DIN
		5263	5263	965	966	7985	7981	7982	7983	7995	7996
		Nm	Nm								
		+	+	+	+	+	+	+	+	+	+
		0	0	1	1	1,6	1,6	1,6	1,8		2
		2	2	3,5	3,9	2,5	2,5	2	2,2	2,2	2,5
		3	3	5	5	3	3	3	2,9	2,9	3
		4	4	8,2	10,3	3,5	3,5	3,5	4,8	4,8	3,5
		5	5	19,5	32	5	5	5	5,5	5,5	5,5
		6	6	38	88,7	8	8	8	6,3	6,3	7
		10	10	10	10						8
		10	10	10	10						8

INDEX	
Flat head	Countersunk head screws
Oval head	Raised (oval) countersunk head screws
Cap	Cheese head screws
Pan head	Pan head screws
Set screws	Grub screws (headless)
Nuts	Hexagon (lock) nuts

		SLOTTED SCREWS																				
		Metric screws (engineering)										Self tapping screws						Wood screws				
		Flat head		Oval head		Cap		Pan head				Set screws		Flat head		Oval head		Pan head		Flat head	Oval head	Round head
		+	+	+	+	+	+	+	+	+	+	+	+	+	+	+	+	+	+	+	+	+
		Min. Torque																				
		DIN	DIN	ISO	DIN	DIN	DIN	DIN	DIN	DIN	DIN	DIN	DIN	ISO	DIN	DIN	DIN	DIN	DIN	DIN	DIN	DIN
		5263	5263	2009	963	2010	964	1207	84	1580	85	920	921	4766	417	7435	427	1482	7972	1483	7973	1481
		97	95	96																		
		+	+	+	+	+	+	+	+	+	+	+	+	+	+	+	+	+	+	+	+	+
		0,40		1,6	1,6	1,6	1,6	1,6	1,6	1,6	2,5	1,6	3,5	3,5								
		-						1,8														1,6
		0,7	0,8	2	2	2	2	2	2		3-3,5	2	4	4	2,2	2,2	2,2		2,2		2	2
		-	1,1							2	3,5	2						2,2			2,5	2,5
		1,3	1,4	2,5	2,5	2,5	2,5	2,5	2,5	4	2,5						2,2		2,2	2,5	2,5	2,5
		-	1,8					2,5	2,5	4	2,5								2,2			2,5
		2,6	2,9	3	3	3	3		3	3	5	3	5	5	2,9	2,9	2,9		2,9	2,9	3	3
				3,5		3,5					3,5		6	6							3,5	3,5
		-	3,9	3,5		3,5		3	3	3	5	3					2,9	2,9	2,9			3,5
		5,5	6,2	3,5	4	3,5	4	3,5	4	3,5	6	4			3,5	3,5	3,5		3,5	3,5	4	4
															3,9				3,9		4,5	4,5
		9,4	10,5	4	5	4	5	4	4				8	8	4,2	4,2	4,2	3,5			5	5
				5	5										4,8	4,8	4,8	3,9				5,5
		11,5	12,9					5	5	4	4	8	5				4,2	4,2	4,2	5,5	5,5	
								5	5								4,8	4,8				6
		20,5	22,9	6	6	6	6							10	10	5,5	5,5	5,5	4,8			6
														12	12	6,3	6,3	6,3				6
		25,6	28,7					6	6	6	6	10	6				5,5	5,5	5,5	7	7	7
																	6,3	6,3	8			8
		48,0	53,8	8	8	8	8	8	8	8	8	8		16		8	6,3	8				8

		HEXAGON SOCKET SCREWS							
		Metric screws							
		Cap			Flat head	Set screws			
		○	⊕	○	○	○	○	○	○
	Min. Torque	ISO 4762				ISO 4026 4029	ISO 4027	ISO 4028	
	DIN	DIN	DIN	DIN	DIN	DIN	DIN	DIN	
	911	912	6912	7984	7991	913 916	914	915	
Size	Nm								
0,7	0,08					1,4	1,4	1,4	
						1,6	1,6	1,6	
						1,8	1,8	1,8	
0,9	0,18					2	2	2	
1,3	0,53	1,4			2,5	2,5	2,5	2,5	
1,5	0,82	1,6-2				3	3	3	
2	1,9	2,5		3	3	4	4	4	
2,5	3,8	3		4	4	5	5	5	
3	6,6	4	4	5	5	6	6	6	
4	16	5	5	6	6	8	8	8	
5	30	6	6	8	8	10	10	10	
6	52	8	8		10	12	12	12	
						14	14	14	
7	78			10					
8	120	10	10	12	12	16	16	16	
10	220	12	12	14	14	18	18	18	
						20	20	20	
12	370	14	14	16	16	22	22	22	
				18	18	24	24	24	
14	590	16	16	20	20				
		18	18	22	22				
17		20	20	24	24				
		22	22						
19		24	24						
		27	27						
22		30	30						
24		33	33						
27		36	36						
32		42							

		HEXAGON HEADED SCREWS								
		Metric screws (engineering)					Screws			
		Screws					Nuts		Self tapping	Wood
		○	⊕	○	○	○	○	○	⊕	⊕
	Min. Torque	ISO 4018	ISO 4016	ISO 4014	ISO 4017	ISO 4035 4036		ISO 1479		
	DIN	DIN	DIN	DIN	DIN	DIN	DIN	DIN	DIN	
	899	558	601	931	933	439	934	7976	571	
Size	Nm									
3,5	1,64							1,8		
4	2,37			2	2	2	2			
4,5	3,30				2,3					
5	4,44			2,5	2,5	2,5	2,5	2,9		
5,5	5,80			3	3	3	3	3,5		
6	7,40			3,5	3,5	3,5	3,5			
7	11,4			4	4	4	4	3,9	4	
								4,2		
8	16,6	5	5	5	5	5	5	4,8	5	
								5,5		
9	23									
10	31	6	6	6	6	6	6	6,3	6	
11	40,4			7	7		7			
12	51,5								7	
13	64,5	8	8	8	8	8	8	8	8	
14	79,4		-	-	-	-	-	-	-	
15	96,2		-	-	-	-	-	-	-	
16	115	10	10	10	10	10				
17	134	10	10	10	10	10	10		10	

THREAD DIAMETER	
	Metric screws
	Metric set screws
	Self tapping screws
	Wood screws

TIP SYMBOLS			
	Slotted		Hex key / Ballpoint
	Phillips-Recess		hexagon
	Pozidriv / Supadriv		Socket wrench - Nut driver
	Torx®		Robertson
	Torx TR®		Reamer

		TORX® SCREWS									
		Metric screws					Self tapping screws				
		Cap	Flat head	Oval head	Cap	Oval flat	Flat head	Pan	Flat head	Oval head	
		⊕	⊕	⊕	⊕	⊕	⊕	⊕	⊕	⊕	
	Min. Torque	DIN	DIN	DIN	DIN	DIN	DIN	DIN	DIN	DIN	
	912	963	964	7984	7985	7986	7981	7972	7973		
		965	966	6912				7982	7983		
T 6	1,72	0,75	0,91	**	**	**	**	**	**	**	
T 7	1,99	1,4	1,7	**	**	**	**	**	**	**	
T 8	2,31	2,2	2,6	2,5	2,5	2,5		2,9	2,9	2,9	
T 9	2,50	2,8	3,4					2,9			
T 10	2,74	3,7	4,5	3	3	3	3	3,5	3,5	3,5	
T 15	3,27	6,4	7,7		3,5	3,5		3,9	3,9	3,9	
T 20	3,86	10,5	12,7	4	4	4	4	4	4,2	4,2	
T 25	4,43	15,9	19,0	5	5	5	5	5	4,8	4,8	
T 27	4,99	22,5	26,9	**	**	**	**	**	**	**	
T 30	5,25	31,1	37,4	6	6	6	6	6	6,3	6,3	
T 40	6,65	54,1	65,1	8	8	8	8	8			
T 45	7,82	86,2	104	**	**	**	**	**	**	**	
T 50	8,83	132	159	10	10	10	10	10			

** special screws

Measuring - convert tables

Approximate comparison of different hardness measure and steel hardness				
Hardness according to				Hardness of steel in N/mm ² N/mm ²
Brinell	Vickers	Rockwell		
HBW	HV	HRB	HRC	
192	192	92	14	690
197	197	93	15	710
201	201	94	16	720
207	207	95	17	750
212	212	96	18	760
217	217	97	19	780
223	223	98	20	800
229	229	99	21	820
235	235	100	22	850
241	241	101	23	870
248	248	102	24	890
255	256	103	25	920
262	263	104	26	940
269	270	105	28	970
277	279	106	29	1000
285	287	107	30	1030
293	296	107	31	1040
302	305	108	32	1090
311	316	109	33	1120
321	327	110	34	1160
330	339	111	35	1190
341	350	111	36	1220
352	363	112	37	1270
363	375	113	38	1310
375	389	113	40	1350
388	404	114	41	1400
400	420	114	42	1440
	437	115	44	1490
	454		45	1550
	473		46	1600
	496		47	1660
	520		49	1720
	546		50	1780
	575		52	1850
	608		53	1920
	645		55	2000
	692		57	2080
	735		58	2160
	790		60	2260
	845		62	2350
	930		64	2460

Conversion of torque units						
measure unit	measure unit					
	= Ncm	= Nm	= kpcm	= kpm	= lbf.in.	= lbf.ft
Ncm	1	0,01	0,10197	0,00102	0,0885	0,00738
Nm	100	1	10,197	0,10197	8,851	0,7376
kpcm	9,807	0,09807	1	0,01	0,868	0,0723
kpm	980,07	9,807	100	1	86,796	7,233
lbf.in.	11,298	0,11298	1,152	0,01152	1	0,0833
lbf.ft.	135,58	1,3558	13,825	0,13825	12	1

Conversion of power units						
measure unit	measure unit					
	= N	= kN	= kg	= g	= mg	= lb
N	1	0,001	0,102	102	102000	0,2248
kN	1000	1	102	102000	102000000	224,8
kg	9,807	0,009807	1	1000	1000000	2,205
g	0,009807	0,000009807	0,001	1	1000	0,002205
mg	0,000009807	9,807e-9	0,000001	0,001	1	0,000002205
lb	4,448	0,004448	0,4536	453,6	453600	1

Conversion of speed units				
measure unit	measure unit			
	= km/s	= m/s	= mph	= sea mile per hour
km/s	1	1000	2237	1944
m/s	0,001	1	2,237	1,944
mph	0,000447	0,447	1	0,869
sea mile per hour	0,0005144	0,5144	1,151	1

Conversion of angle units			
measure unit	measure unit		
	= deg	= rad	= grad
deg	1	0,01745	1,111
rad	57,3	1	63,66
grad	0,9	0,01571	1

Conversion of flow rates			
measure unit	measure unit		
	l/min	m ³ /min	cm ³ /min
l/min	1	0,001	1000
m ³ /min	1000	1	1000000
cm ³ /min	0,001	0,000001	1

Paper formats according to ISO					
A		B		C	
4A0	1682 x 2378	-	-	-	
2A0	1189 x 1682	-	-	-	
A0	841 x 1189	B0	1000 x 1414	C0	917 x 1297
A1	594 x 841	B1	707 x 1000	C1	648 x 917
A2	420 x 594	B2	500 x 707	C2	458 x 648
A3	297 x 420	B3	353 x 500	C3	324 x 458
A4	210 x 297	B4	250 x 353	C4	229 x 324
A5	148 x 210	B5	176 x 250	C5	162 x 229
A6	105 x 148	B6	125 x 176	C6	114 x 162
A7	74 x 105	B7	88 x 125	C7	81 x 114
A8	52 x 74	B8	62 x 88	C8	57 x 81
A9	37 x 52	B9	44 x 62	C9	40 x 57
A10	26 x 37	B10	31 x 44	C10	28 x 40

Conversion of geometric units								
measure unit	measure unit							
	= inch	= yard	= foot	= km	= m	= mm	= micron	= nm
inch	1	0,02778	0,08333	0,0000254	0,0254	25,4	25400	25400000
yard	36	1	3	0,0009144	0,9144	914,4	914400	914400000
foot	12	0,3333	1	0,0003048	0,3048	304,8	304800	304800000
km	39370	1094	3281	1	1000	1000000	1000000000	1000000000000
m	39,37	1,094	3,281	0,001	1	1000	1000000	1000000000
mm	0,03937	0,001094	0,003281	0,000001	0,001	1	1000	1000000
micron	0,00003937	0,00001094	0,000003281	1e-9	0,000001	0,001	1	1000
nm	3,937e-8	1,094e-9	0,000	1e-12	1e-9	0,000001	0,001	1

Conversion of energy units							
measure unit	measure unit						
	= kJ	= kcal	= cal	= kWh	= Wh	= Ws	= BTU
kJ	1	0,2388	238,8	0,0002778	0,2778	1000	0,9478
kcal	4,187	1	1000	0,001163	1,163	4187	3,968
cal	0,004187	0,001	1	0,00001163	0,001163	4,187	0,003968
kWh	3600	859,8	859800	1	1000	3600000	3412
Wh	3,6	0,8598	859,8	0,001	1	3600	3,412
Ws	0,001	0,0002388	0,2388	2,778e-7	0,0002778	1	0,0009478
BTU	1,055	0,252	252	0,0002931	0,2931	1055	1

Conversion of pressure units							
measure unit	measure unit						
	= bar	= kPa	= hPa	= milibar	= Pa	= kgf/m2	= psi
bar	1	100	1000	1000	100000	10200	14,5
kPa	0,01	1	10	10	1000	102	0,145
hPa	0,001	0,1	1	1	100	10,2	0,0145
milibar	0,001	0,1	1	1	100	10,2	0,0145
Pa	0,00001	0,001	0,01	0,01	1	0,102	0,000145
kgf/m2	0,00009807	0,009807	0,09807	0,09807	9,807	1	0,001422
psi	0,06895	6,895	68,95	68,95	6895	703,1	1

Measuring - convert tables

- to convert to MILLIMETERS: multiply INCHES x 25,4
- to convert to INCHES: multiply MILLIMETERS x 0,03937

INCHES		METRIC
fractional	decimal	mm
.	0.0039	0.1000
.	0.0079	0.2000
.	0.0118	0.3000
1/64	0.0156	0.3969
.	0.0157	0.4000
.	0.0197	0.5000
.	0.0236	0.6000
.	0.0276	0.7000
1/32	0.0313	0.7938
.	0.0315	0.8000
.	0.0354	0.9000
.	0.0394	1.0000
.	0.0433	1.1000
3/64	0.0469	1.1906
.	0.0472	1.2000
.	0.0512	1.3000
.	0.0551	1.4000
.	0.0591	1.5000
1/16	0.0625	1.5875
.	0.0630	1.6000
.	0.0669	1.7000
.	0.0709	1.8000
.	0.0748	1.9000
5/64	0.0781	1.9844
.	0.0787	2.0000
.	0.0827	2.1000
.	0.0866	2.2000
.	0.0906	2.3000
3/32	0.0938	2.3813
.	0.0945	2.4000
.	0.0984	2.5000
7/64	0.1094	2.7781
.	0.1181	3.0000
1/8	0.1250	3.1750
.	0.1378	3.5000
9/64	0.1406	3.5719
5/32	0.1563	3.9688
.	0.1575	4.0000
11/64	0.1719	4.3656
.	0.1772	4.5000
3/16	0.1875	4.7625
.	0.1969	5.0000
13/64	0.2031	5.1594
.	0.2165	5.5000
7/32	0.2188	5.5563
15/64	0.2344	5.9531
.	0.2362	6.0000
1/4	0.2500	6.3500
.	0.2559	6.5000
17/64	0.2656	6.7469
.	0.2756	7.0000
9/32	0.2813	7.1438
.	0.2953	7.5000
19/64	0.2969	7.5406
5/16	0.3125	7.9375
.	0.3150	8.0000
21/64	0.3281	8.3344
.	0.3346	8.5000
11/32	0.3438	8.7313
.	0.3543	9.0000
23/64	0.3594	9.1281
.	0.3740	9.5000
3/8	0.3750	9.5250
25/64	0.3906	9.9219
.	0.3937	10.0000
13/32	0.4063	10.3188
.	0.4134	10.5000
27/64	0.4219	10.7156
.	0.4331	11.0000
7/16	0.4375	11.1125
.	0.4528	11.5000
29/64	0.4531	11.5094
15/32	0.4688	11.9063
.	0.4724	12.0000
31/64	0.4844	12.3031
.	0.4921	12.5000
1/2	0.5000	12.7000
.	0.5118	13.0000
33/64	0.5156	13.0969
17/32	0.5313	13.4938
.	0.5315	13.5000
35/64	0.5469	13.8906

INCHES		METRIC
fractional	decimal	mm
.	0.5512	14.0000
9/16	0.5625	14.2875
.	0.5709	14.5000
37/64	0.5781	14.6844
.	0.5906	15.0000
19/32	0.5938	15.0813
39/64	0.6094	15.4781
.	0.6102	15.5000
5/8	0.6250	15.8750
.	0.6299	16.0000
41/64	0.6406	16.2719
.	0.6496	16.5000
21/32	0.6563	16.6688
.	0.6693	17.0000
43/64	0.6719	17.0656
11/16	0.6875	17.4625
.	0.6890	17.5000
45/64	0.7031	17.8594
.	0.7087	18.0000
23/32	0.7188	18.2563
.	0.7283	18.5000
47/64	0.7344	18.6531
.	0.7480	19.0000
3/4	0.7500	19.0500
49/64	0.7656	19.4469
.	0.7677	19.5000
25/32	0.7813	19.8438
.	0.7874	20.0000
51/64	0.7969	20.2406
.	0.8071	20.5000
13/16	0.8125	20.6375
.	0.8268	21.0000
53/64	0.8281	21.0344
27/32	0.8438	21.4313
.	0.8465	21.5000
55/64	0.8594	21.8281
.	0.8661	22.0000
7/8	0.8750	22.2250
.	.8858	22.5000
57/64	.89063	22.6219
.	.9055	23.0000
29/32	.90625	23.0188
59/64	.92188	23.4156
.	.9252	23.5000
15/16	.93750	23.8125
.	.9449	24.0000
61/64	.95313	24.2094
.	.9646	24.5000
31/32	.96875	24.6063
.	.9843	25.0000
63/64	.98438	25.0031
1	1.000	25.40
.	1.0039	25.5000
.	1.0236	26.0000
.	1.0433	26.5000
.	1.0630	27.0000
.	1.0827	27.5000
.	1.1024	28.0000
.	1.1220	28.5000
.	1.1417	29.0000
.	1.1614	29.5000
.	1.1811	30.0000
.	1.2205	31.0000
1 1/4	1.2500	31.7500
.	1.2598	32.0000
.	1.2992	33.0000
.	1.3386	34.0000
.	1.3780	35.0000
.	1.4173	36.0000
.	1.4567	37.0000
.	1.4961	38.0000
1 1/2	1.5000	38.1000
.	1.5354	39.0000
.	1.5748	40.0000
.	1.6142	41.0000
.	1.6535	42.0000
.	1.6929	43.0000
.	1.7323	44.0000
1 3/4	1.7500	44.4500
.	1.7717	45.0000
.	1.8110	46.0000
.	1.8504	47.0000

INCHES		METRIC
fractional	decimal	mm
.	1.8898	48.0000
.	1.9291	49.0000
.	1.9685	50.0000
2	2.0000	50.8000
.	2.0079	51.0000
.	2.0472	52.0000
.	2.0866	53.0000
.	2.1260	54.0000
.	2.1654	55.0000
.	2.2047	56.0000
.	2.2441	57.0000
2 1/4	2.2500	57.1500
.	2.2835	58.0000
.	2.3228	59.0000
.	2.3622	60.0000
.	2.4016	61.0000
.	2.4409	62.0000
.	2.4803	63.0000
2 1/2	2.5000	63.5000
.	2.5197	64.0000
.	2.5591	65.0000
.	2.5984	66.0000
.	2.6378	67.0000
.	2.6772	68.0000
.	2.7165	69.0000
2 3/4	2.7500	69.8500
.	2.7559	70.0000
.	2.7953	71.0000
.	2.8346	72.0000
.	2.8740	73.0000
.	2.9134	74.0000
.	2.9528	75.0000
.	2.9921	76.0000
3	3.0000	76.2000
.	3.0315	77.0000
.	3.0709	78.0000
.	3.1102	79.0000
.	3.1496	80.0000
.	3.1890	81.0000
.	3.2283	82.0000
.	3.2677	83.0000
.	3.3071	84.0000
.	3.3465	85.0000
.	3.3858	86.0000
.	3.4252	87.0000
.	3.4646	88.0000
3 1/2	3.5000	88.9000
.	3.5039	89.0000
.	3.5433	90.0000
.	3.5827	91.0000
.	3.6220	92.0000
.	3.6614	93.0000
.	3.7008	94.0000
.	3.7402	95.0000
.	3.7795	96.0000
.	3.8189	97.0000
.	3.8583	98.0000
.	3.8976	99.0000
.	3.9370	100.0000
4	4.0000	101.6000
.	4.3307	110.0000
4 1/2	4.5000	114.3000
.	4.7244	120.0000
5	5.0000	127.0000
.	5.1181	130.0000
.	5.1118	140.0000
.	5.9055	150.0000
6	6.0000	152.4000
.	6.2992	160.0000
.	6.6929	170.0000
.	7.0866	180.0000
.	7.4803	190.0000
.	7.8740	200.0000
8	8.0000	203.2000
.	9.8425	250.0000
10	10.0000	254.0000
20	20.0000	508.0000
30	30.0000	762.0000
40	40.0000	1016.0000
60	60.0000	1524.0000
80	80.0000	2032.0000
100	100.0000	2540.0000





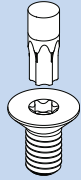

TX screws

			
		mm	
TX 1			0,84
TX 2			0,94
TX 3			1,12
TX 4			1,30
TX 5			1,37
TX 6			1,65
TX 7			1,97
TX 8			2,30
TX 9			2,48
TX 10			2,72
TX 15			3,26
TX 20			3,84
TX 25			4,40
TX 27			4,96
TX 30			5,49
TX 40			6,60
TX 45			7,77
TX 50			8,79
TX 55			11,17
TX 60			13,20
TX 70			15,49

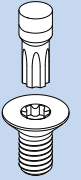

TXP screws

			
		mm	
1	IP		0,84
2	IP		0,95
3	IP		1,13
4	IP		1,29
5	IP		1,41
6	IP		1,69
7	IP		1,97
8	IP		2,29
9	IP		2,48
10	IP		2,72
15	IP		3,25
20	IP		3,84
25	IP		4,39
27	IP		4,95
30	IP		5,49
40	IP		6,60
45	IP		7,77
50	IP		8,79
55	IP		11,16
60	IP		13,20
70	IP		15,48

TQ screws

			
		mm	
0			0,43
1			0,43
2			0,43
3			0,48
4			0,56
5			0,63
6			0,71
8			0,84
10			0,96
1/4"			1,27
5/16"			1,60
3/8"			1,90
7/16"			2,23
1/2"			2,54



TW screws

			
		mm	
0			0,45
1			0,57
2			0,75
3			0,95
4			1,08
5			1,23
6			1,54
7			1,87
8			2,17
9			2,48
10			2,78

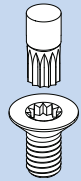

ZX screws

			
M 4			3,83
M 5			4,80
M 6			6,00
M 8			7,20
M 10			9,60
M 12			11,41
M 14			13,22
M 16			15,63
M 18			16,85
M 20			19,25

SQ screws

				
00			1,27	1,4
0			1,78	2
1			2,31	2,5
2			2,85	3,1
3			3,37	3,7
4			4,84	5,1

SP screws

			
		mm	
4			1,52
6			2,41
8			2,79
10			3,30

Measuring - convert tables

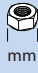
 M	BOLT GRADE									 mm
	3.6	4.6	5.6	5.8	6.8	8.8	9.8	10.9	12.9	
	torque in Nm									
M 1.6	0.05	0.07	0.09	0.11	0.14	0.18	0.21	0.26	0.31	3.2
M 2	0.11	0.14	0.18	0.24	0.28	0.38	0.42	0.53	0.63	4
M 2.5	0.22	0.29	0.36	0.48	0.58	0.78	0.87	1.09	1.31	5
M 3	0.38	0.51	0.63	0.84	1.01	1.35	1.52	1.9	2.27	5.5
M 4	0.71	0.95	1.19	1.59	1.91	2.54	2.86	3.57	4.29	7
M 5	1.71	2.28	2.85	3.8	4.56	6.09	6.85	8.56	10.3	8
M 6	2.94	3.92	4.91	6.54	7.85	10.5	11.8	14.7	17.7	10
M 8	7.11	9.48	11.9	15.8	19	25.3	28.4	35.5	42.7	13
M 10	14.3	19.1	23.8	31.8	38.1	50.8	57.2	71.5	85.8	17
M 12	24.4	32.6	40.7	54.3	65.1	86.9	97.7	122	147	19
M 14	39	52	65	86.6	104	139	156	195	234	22
M 16	59.9	79.9	99.8	133	160	213	240	299	359	24
M 18	82.5	110	138	183	220	293	330	413	495	27
M 20	117	156	195	260	312	416	468	585	702	30
M 22	158	211	264	352	422	563	634	792	950	32
M 24	202	270	337	449	539	719	809	1011	1213	36
M 27	298	398	497	663	795	1060	1193	1491	1789	41
M 30	405	540	675	900	1080	1440	1620	2025	2430	46
M 33	550	734	917	1223	1467	1956	2201	2751	3301	50
M 36	708	944	1180	1573	1888	2517	2832	3540	4248	55
M 39	919	1226	1532	2043	2452	3269	3678	4597	5517	60
M 42	1139	1518	1898	2530	3036	4049	4555	5693	6832	65
M 45	1425	1900	2375	3167	3800	5067	5701	7126	8551	70
M 48	1716	2288	2860	3813	4576	6101	6864	8580	10296	75
M 52	2210	2947	3684	4912	5895	7859	8842	11052	13263	80
M 56	2737	3650	4562	6083	7300	9733	10950	13687	16425	85
M 60	3404	4538	5673	7564	9076	12102	13614	17018	20422	90
M 64	4100	5466	6833	9110	10932	14576	16398	20498	24597	95
M 68	4963	6617	8271	11029	13234	17646	19851	24814	29777	100